

Corma Vacuum Forming Corrugators

Model 053

For pipe sizes:
0.12 inches I.D. to
0.80 inches O.D.
(3 mm I.D. to
20 mm O.D.)

Model I30

For pipe sizes:
0.25 inches I.D. to
4.50 inches O.D.
(6 mm I.D. to
110 mm O.D.)



CI Corma Inc.

10 McCleary Court
Concord (Toronto)
Ontario, Canada
L4K 2Z3
Tel.: (905) 669-9397
Fax: (905) 738-4744
Internet: <http://www.corma.com>
E-mail: info@corma.com



*Model I30 illustrated**

Some of the advantages of Corma Corrugators that have made the Model 053 and I30 series best sellers, the world over:

- Corma corrugators feature very strong and precise construction, able to withstand the rigorous demands of day to day production. All Corma corrugators are backed by a three year mechanical warranty.
- Corma corrugators are of vertical construction. This design is extremely user friendly and has been proven for over 40 years. The top and bottom housings are held in place by four columns which keep the machine in perfect alignment. With the centre height adjustment, each Corma corrugator can make a very large range of pipe sizes; providing production flexibility at lower capital investment.
- Corma corrugators accept almost all blow and vacuum formable materials including PVC, PE, PP, Nylon, TPR, Teflon and others. Modifiers such as flame retardants, EVA etc. can be added.
- Corma corrugators are available in either blow molding or vacuum forming design.
- Corma corrugators are manufactured under strict ISO 9001-2008 procedures to meet customers' requirements and bear the CE stamp of conformity to the European technical and safety standard.

Corma offers standard systems capable of producing pipes of virtually all sizes, from extremely small pipes with inside diameter measuring as little as 1 mm (0.040 in.) to enormous pipes with outside diameters measuring as much as 3000 mm (120 in.).

Corma supplies Single Wall, Double Wall, Triple Wall, Rib Pipe, Ultra Rib, and Corma Solid Wall pipe production systems as complete turnkey installations or as individual components.

Corma Inc.

10 McCleary Court
Concord (Toronto)
Ontario, Canada L4K 2Z3
Tel: (905) 669-9397
Fax: (905) 738-4744
Internet: <http://www.corma.com>
E-mail: info@corma.com

International Sales and Service Offices:

Corma Deutschland GmbH

Immermannstraße 13
D-40210 Düsseldorf
Germany
Tel: 49-211-434688
Fax: 49-211-9350150

Corma Eastern Europe

Fatranska Str. 3
P.O. Box 28 D
94901 Nitra
Slovakia
Tel: 421 37 653 7420
Fax: 421 37 653 7420
E-mail: tkrivosisik@corma.com

Corma Shanghai Co., Ltd.

588 Qiangye Road
Sheshan Industrial Zone
Songjiang District, Shanghai
201602
P.R. China
Tel: 86-21-5779-4175 & 6
Fax: 86-21-5779-4159
E-mail: cormash@mail.online.sh.cn

Corma Latin America

Avenida los Eucaliptos 3-C,
Brisas de las Mercedes
Zaragoza, La Libertad, El Salvador
Central America
Tel: 503-2566-2297
Fax: 503-7797-5667
E-mail: fsolano@corma.com

Corma India

1124, Regus Grandeur,
Earth Arise Building,
S.G Road, Makarba
Ahmedabad - 380015
Gujarat, India
Tel: 91-79-6134-4542
E-mail: bpawar@corma.com

Technical Data

Specifications	Model 053	Model 130-HS	Model 130-HSL
Pipe range Min I.D.	3 mm 0.12 in	6 mm 0.25 in	6 mm 0.25 in
Pipe range Max O.D.	20 mm 0.80 in	110 mm 4.50 in	110 mm 4.50 in
Max. line speed*	50 m/min 165 ft/min	50 m/min 165 ft/min	55 m/min 180 ft/min
Max. output*	30 kg/hr 66 lbs/hr	205 kg/hr 450 lbs/hr	360 kg/hr 790 lbs/hr
Set of moldblocks	80 pairs 80 prs.	80 pairs 80 prs.	120 pairs 120 prs.
Moldblock length	25.4 mm 1.00 in	50.8 mm 2.00 in	50.8 mm 2.00 in
Moldblock chain length	2032 mm 80 in	4065 mm 160 in	6100 mm 240 in
Forming section length	832 mm 33 in	1650 mm 65 in	2665 mm 105 in
Corrugator drive motor	0.4 kw (x2) 0.5 hp (x2)	1 kw (x2) 1.5 hp (x2)	1kw (x2) 1.5 hp (x2)
Cooling unit fans	0.195 kw(x2) 0.26 (x2)	0.195 kw(x4) 0.26 (x4)	0.195 kw(x4) 0.26 (x4)
Corrugator lifter motor	Manual	0.56 kw 0.75 hp	0.56 kw 0.75 hp
Corrugator hook-up	2.4 kw 3.1 hp	3 kw 4 hp	4.5 kw 6 hp
Water cooling required	20 l/min 5 gl/min	40 l/min 10.5 gl/min	40 l/min 10.5 gl/min
Air pressure hook-up	6 bar 87 psi	6 bar 87 psi	6 bar 87 psi

*Line speeds and outputs are theoretical and depend on: pipe diameter; type of plastic; machine model; cooling options; mold track length; temperature and quantity of cooling water; profile configuration; extruder capacity, etc.

Note: Corma reserves the right to change specifications in the interest of progress without prior notice.

Dimensions

	Model 053	Model 130-HS	Model 130-HSL
A) Centre height	1100 mm 43 1/4 in	1150 mm 45 1/4 in	1150 mm 45 1/4 in
B) Length	1600 mm 63 in	3020 mm 119 in	4040 mm 159 in
C) Width	900 mm 35.5 in	1320 mm 52 in	1320 mm 52 in
D) Weight approx.	700 kg 1540 lbs	1860 kg 4100 lbs	2410 kg 5200 lbs

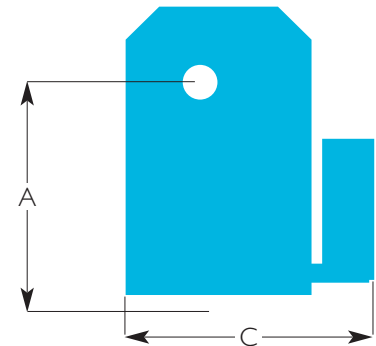
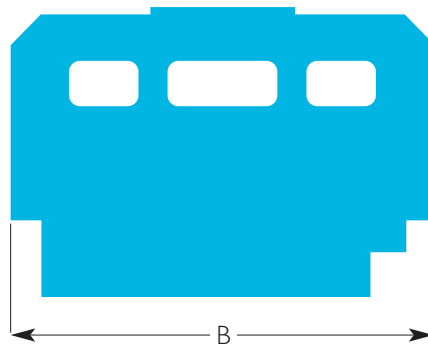

*Picture not exactly as shown and may include, among other things, attached guards and safety devices, as set out in manufacturer's specifications.

Elements of the technology, operations and applications outlined herein are patented worldwide in selected countries, and are the sole property of Corma Inc.

Any publication in whole or in part is subject to authorization by Corma Inc.

Corma reserves the right, in the interest of technical advancement, to change the designs and specifications without prior notice.

Printed in Canada. © May 2017 by Corma Inc.